

MALDIVES LAND AND SURVEY AUTHORITY**MINISTRY OF HOUSING AND INFRASTRUCTURE**

Office (PABX): +(960) 3004300, Fax: +(960) 3004254

Email: survey@housing.gov.mvWeb: www.surveyofmaldives.gov.mv

Ameenee Magu, Maafannu, Male', 20392, Maldives



CONTROL POINT DETAILS		Station Number: PSM0259
Coordinate Information		
Geodetic		Grid
WGS 84		UTMSouth-Zone_43 : 72E to 78E
Lat: 3°04'57.29136"N		E: 273642.203m
Long: 72°57'47.81220"E		N: 340937.531m
Ellp Height: -104.038m		Orth Height: +1.021 from MSL

Island Name: F. Magoodhoo	Date: 24 October 2019
---------------------------	-----------------------

Monument description & method of survey:

- Fixed to a type A monument specifications. Concrete caste in situ to a diameter 0.3m pvc pipe, 1m in length, 1.5m s/s driven to ground as center with cross mark. Monument labelled with s/s plate with point ID (PSM0259).
- Below 150mm from ground level.
- GNSS Static Survey was done by using 2 Topcon GR-5 differential GPS.
- • Vertical datum (MSL) derived from Water level measured at Magoodhoo referred to PSM0260 using K. Hulhule Predicted Tide. Level transferred to PSM0259 from PSM0260 at Magoodhoo using Ellipsoid heights derived from static survey.

General site condition & access:

- PSM0259 is established on the south east of the existing harbor.
- Below ground
- Easy access.

Owner: Secretariat of Faafu Magoodhoo

North Height: 1.6m Distance: 2.0m	Sky view from PSM Height: 1.5m	West Height: 1.5m Distance: 2.5m
South Height: 1.5m Distance: 2.0m	Top of PSM Height: 0.5m	East Height: 1.5m Distance: 2.0m

SITE INFORMATION

Station Number

P	S	M	0	2	5	9
---	---	---	---	---	---	---

Station Horizon Mask

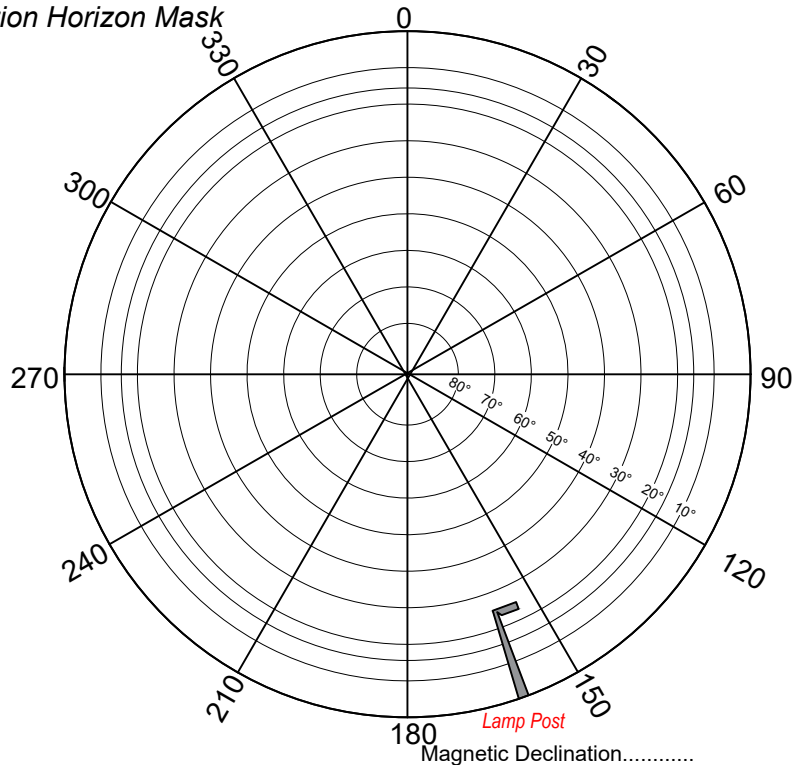

Height above Marker horizon was mapped from 1.500 m

Magnetic Declination.....
Declination applied to this figure?
 Yes No

Locality

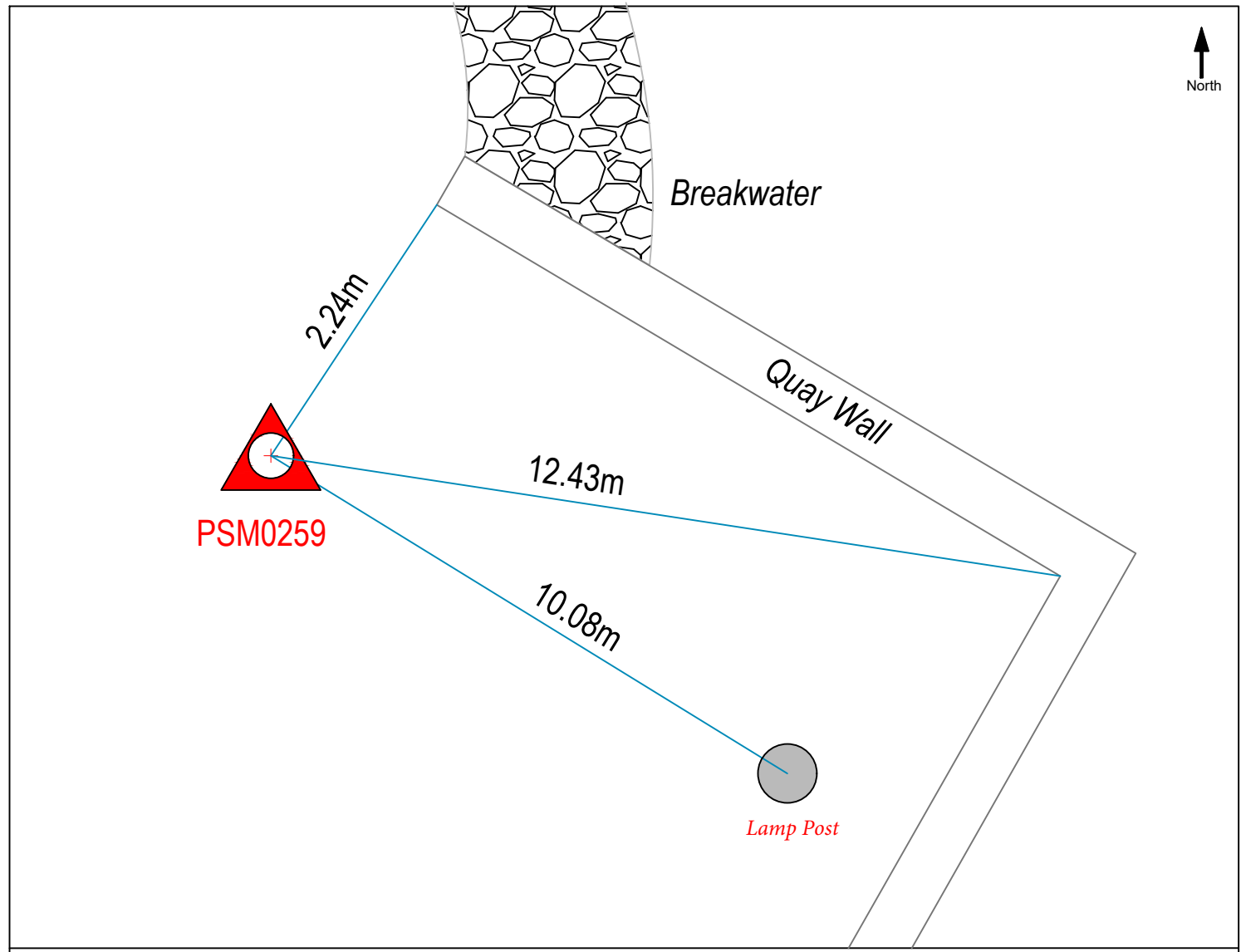

Sketched by: Ibrahim Mizal Mohamed

Scale: Not to scale

Date: 24 October 2019

MALDIVES LAND AND SURVEY AUTHORITY**MINISTRY OF HOUSING AND INFRASTRUCTURE**

Office (PABX): +(960) 3004300, Fax: +(960) 3004254

Email: survey@housing.gov.mvWeb: www.surveyofmaldives.gov.mv

Ameenee Magu, Maafannu, Male', 20392, Maldives

**CONTROL POINT DETAILS**

Station Number: PSM0260

Coordinate Information

Geodetic

Grid

WGS 84

UTMSouth-Zone_43 : 72E to 78E

Lat: 3°04'51.81937"N

E: 273854.210m

Long: 72°57'54.68705"E

N: 340769.009m

Ellp Height: -104.004m

Orth Height: +1.055m from MSL

Island Name: Magoodhoo

Date: 24 October 2019

Monument description & method of survey:

- Fixed to a type A monument specifications. Concrete caste in situ to a diameter 0.3m pvc pipe, 1m in length, 1.5m s/s driven to ground as center with cross mark. Monument labelled with s/s plate with point ID (PSM0260).
- Below 150mm from ground level.
- GNSS Static Survey was done by using 2 Topcon GR-5 differential GPS.
- Vertical datum (MSL) derived from Water level measured at Magoodhoo referred to PSM0260 using K. Hulhule Predicted Tide.

General site condition & access:

- PSM0260 is established on the north west of the existing harbor.
- Below ground.
- Easy access.

Owner: Secretariat of Faafu Magoodhoo

North

Sky view from PSM

West



South

Top of PSM

East



MALDIVES LAND AND SURVEY AUTHORITY**MINISTRY OF HOUSING AND INFRASTRUCTURE**

Office (PABX): +(960) 3004300, Fax: +(960) 3004254

Email: survey@housing.gov.mv

Web: www.surveyofmaldives.gov.mv

Ameenee Magu, Maafannu, Male', 20392, Maldives

**CONTROL POINT DETAILS**

Station Number: PSM0261

Coordinate Information

Geodetic

Grid

WGS 84

UTMSouth-Zone_43 : 72E to 78E

Lat: 3°04'39.04556"N

E: 273670.866m

Long: 72°57'48.77493"E

N: 340376.906m

Ellp Height: -103.763m

Orth Height: +1.296m from MSL

Island Name: Magoodhoo

Date: 24 October 2019

Monument description & method of survey:

- Fixed to a type A monument specifications. Concrete caste in situ to a diameter 0.3m pvc pipe, 1m in length, 1.5m s/s driven to ground as center with cross mark. Monument labelled with s/s plate with point ID (PSM0261).
- Below 150mm from ground level.
- GNSS Static Survey was done by using 2 Topcon GR-5 differential GPS.
- Vertical datum (MSL) derived from Water level measured at Magoodhoo referred to PSM0260 using K. Hulhule Predicted Tide. Level transferred to PSM0261 from PSM0260 at Magoodhoo using Ellipsoid heights derived from static survey.

General site condition & access:

- PSM0261 is established on the northern side of the island.
- Easy access, inside bush vegetation.

Owner: Secretariat of Faafu Magoodhoo

NorthHeight: 1.5m
Distance: 2.0m**Sky view from PSM**

Height: 1.5m

WestHeight: 1.5m
Distance: 2.0m**South**Height: 1.5m
Distance: 2.0m**Top of PSM****East**Height: 1.5m
Distance: 2.0m

SITE INFORMATION

Station Number

P	S	M	0	2	6	1
---	---	---	---	---	---	---

Station Horizon Mask

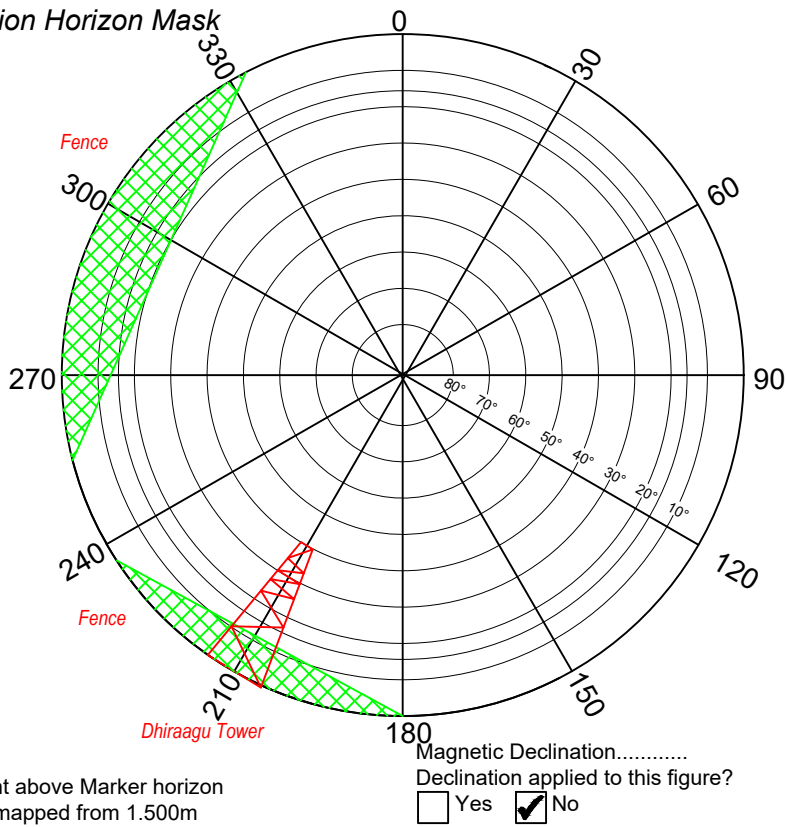

Locality

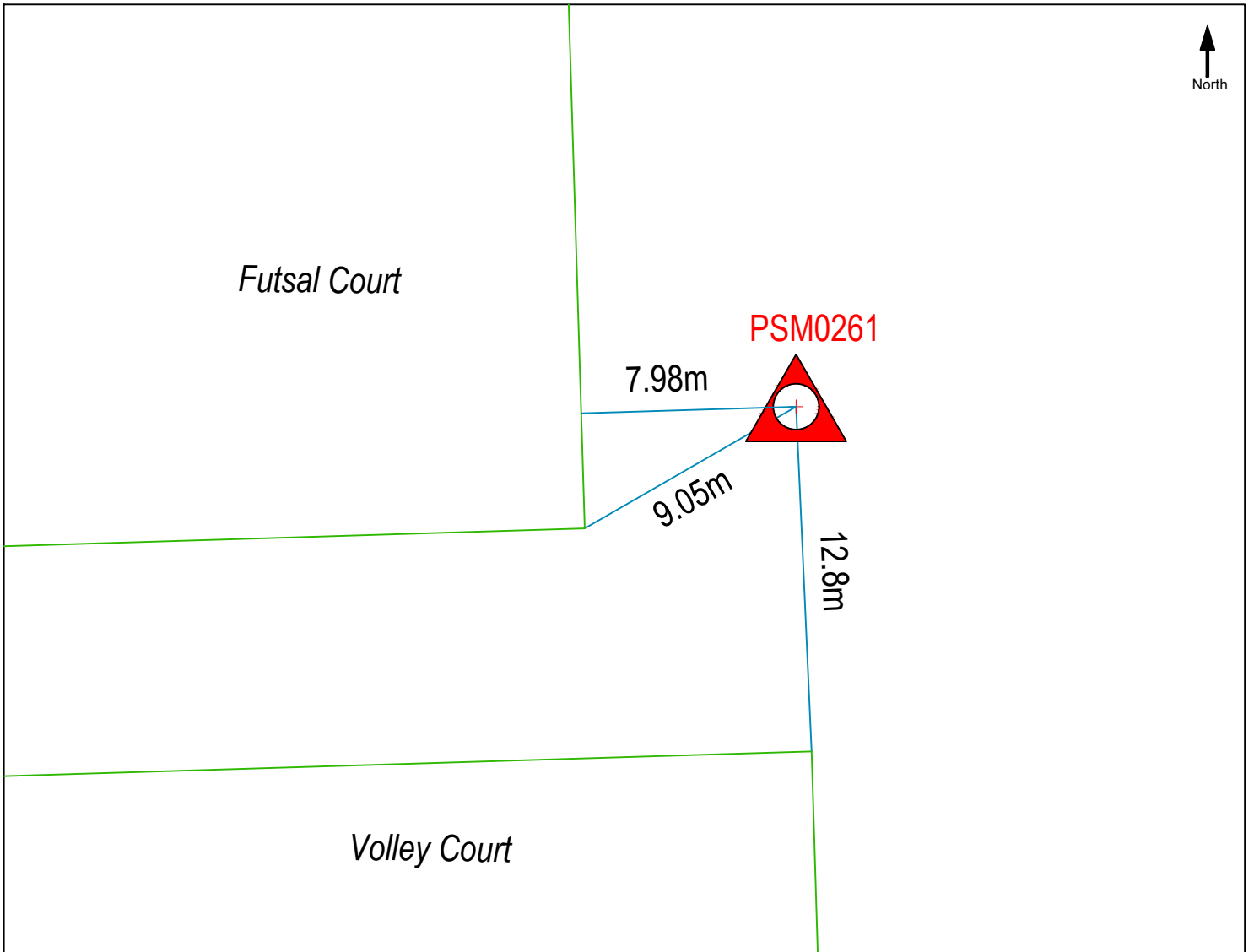

Sketched by: Ibrahim Mizal Mohamed

Scale: Not to scale

Date: 24 October 2019